

## Installation Guide for Universal and 20k Universal Tile Vent



Step by step guide for Universal and 20k Universal Tile Vent. Suitable for most concrete interlocking tiles and plain tiles with a pitch over 17.5

### Universal Tile Vent

KG985403      KG985430  
 KG985434      KG985436  
 KG985476

### 20k Universal Tile Vent

KG 9854-20-0429  
 KG 9854-20-0152  
 KG 9854-20-0247

### Universal and 20k Universal Tile Vent Installation Guide

Position the Tile vent where required and ensure the vent is directly in line with the tile below. (Do not at this stage lay tile to either side). Use the vent to draw the template to mark the hole.



Cut the underlay diagonally as a cross shape as shown above, then pin the underlay back to surrounding battens and rafters. Position the vent into the cut hole.



All tile vents should be mechanically fixed in accordance with BS 5534 as shown. Lay tiles to both sides of base once nailed. Remove protective tape and dress skirt to the profile of the tile.

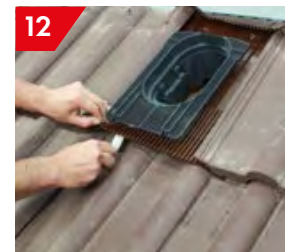

Once Tile Vent is dressed to the tile, clip the cap onto the base securely. Carry on tiling as normal



### Adaptor Installation

If the tile vent is to be used as an outlet then an adaptor will be required to allow connection to the flexible pipe and ducting. The adaptor should be securely clipped onto the spigot on the back of the tile vent. The adaptor shown here is the 20k adaptor (KG979700), with a 150mm diameter for use with the 20k tile vent. The universal tile vent is compatible with the 100mm adaptor (KG968300-1) and the 125mm adaptor (KG979000-1).



If the vent tile is being used for roofspace ventilation only, the spigot on the back of the vent tile should be left open as shown'

